



# SBLFT 100-12i



Nominal voltage	12 V
Nominal capacity	106 Ah @ C20 dla rozładowania do 1,75 V/celę
	100 Ah @ C10 dla rozładowania do 1,80 V/celę
Technology	AGM (Absorbent Glass Mat)
	VRLA (Valve Regulated Lead Acid)
Weight	~ 31 kg
Design life time	12 years (standby use)
	Long Life acc. Eurobat
Internal resistance	~ 6 mΩ (full charged)

Operating temperature range	Discharge -20°C ~ +60°C
	Charge 0°C ~ +50°C
	Storage -20°C ~ +60°C
Max. discharge current	1000 A (5 sec)
Short circuit current	30 A
Charging voltage	Standby use 13,6 - 13,8 VDC
	Cycle use 14,6 - 14,8 VDC
Self discharge	Monthly is less than 3% at 25°C
Container material	ABS UL94HB (optional UL94-V0)
Additional option	Centralized venting system

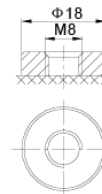
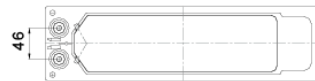
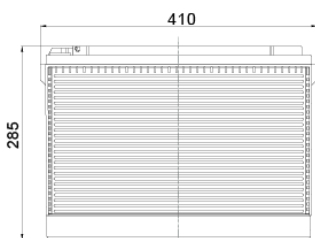

Length	410 ±2 mm
Width	109 ±2 mm
Height	285 ±2 mm
Total height	286 ±2 mm
Terminal types	Internal thread M8 (breaking torque 10-12 Nm)

## CONSTANT CURRENT DISCHARGE CHARACTERISTICS (A at 25°C)

Voltage/Time	10 MIN	15 MIN	30 MIN	60 MIN	2 H	3 H	4 H	5 H	8 H	10 H	20 H
1.60V	246,3	185,3	109,5	61,1	36,4	28,2	22,20	18,90	12,70	10,50	5,52
1.65V	232,7	177,1	105,1	59,0	35,2	27,3	21,60	18,40	12,50	10,40	5,43
1.70V	214,2	165,9	100,5	57,1	34,1	26,6	21,00	17,90	12,30	10,30	5,36
1.75V	196,1	154,4	96,0	55,0	32,9	25,8	20,40	17,40	12,20	10,10	5,30
1.80V	177,5	142,5	91,8	52,9	31,7	25,0	19,90	17,00	12,00	10,00	5,25
1.85V	145,1	118,3	79,0	47,4	29,1	23,1	18,50	15,90	11,20	9,41	4,98

## CONSTANT POWER DISCHARGE CHARACTERISTICS (W/cell at 25°C)

Voltage/Time	10 MIN	15 MIN	30 MIN	60 MIN	2 H	3 H	4 H	5 H	8 H	10 H	20 H
1.60V	418,6	323,9	198,9	114,8	69,00	53,90	42,60	36,40	24,80	20,70	10,90
1.65V	403,2	314,2	192,9	111,5	67,10	52,40	41,60	35,60	24,50	20,50	10,70
1.70V	378,0	298,7	186,2	108,6	65,30	51,20	40,60	34,80	24,20	20,20	10,60
1.75V	352,2	282,0	179,8	105,2	63,30	49,90	39,70	34,00	23,90	20,00	10,50
1.80V	324,4	264,1	173,6	101,8	61,30	48,60	38,70	33,20	23,60	19,80	10,40
1.85V	269,8	222,2	151,0	91,9	56,50	45,10	36,10	31,10	22,20	18,60	9,87

EFFECT OF TEMPERATURE ON LONG TERM LIFE

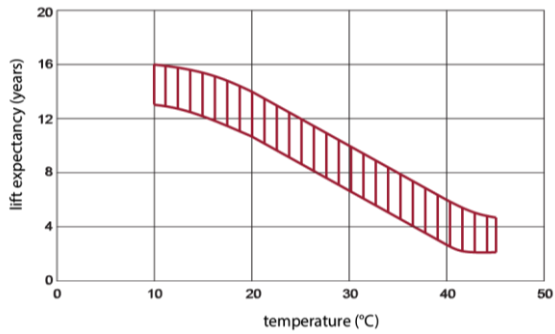

CYCLE LIFE IN RELATION TO DEPTH OF DISCHARGE

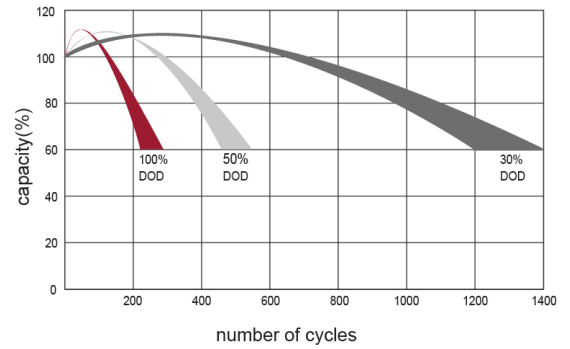

DISCHARGE CHARACTERISTICS CURVE

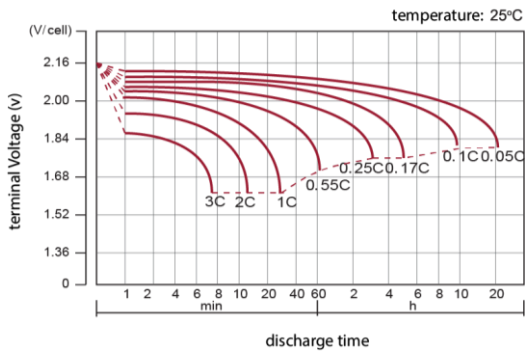

CHARGE CHARACTERISTIC CURVE FOR CYCLE USE

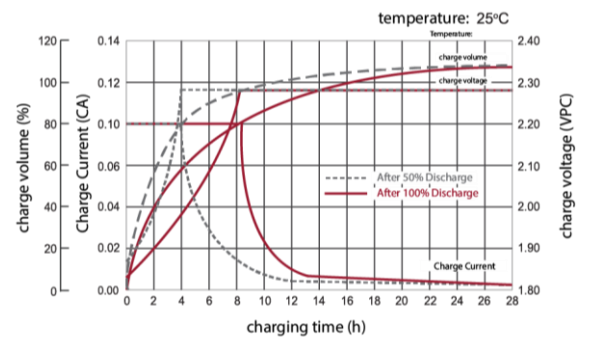

RELATIONSHIP BETWEEN CHARGING VOLTAGE AND TEMPERATURE

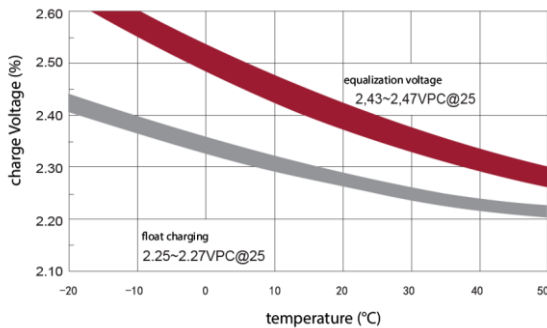

STORAGE CHARACTERISTICS



**Standards met:**

PN-EN 60896-21:2007 • PN-EN 60896-22:2007 • PN-EN 61056-1:2013 • PN-EN 61056-2:2013 • PN-E-83016:1999

Batteries manufactured in compliance with: ISO 9001 • ISO 14001

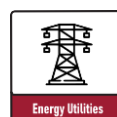
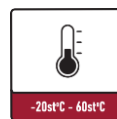

All data contained in this document, are subject to change. Wamtechnik Sp. z o.o. reserves the right to change them without prior notice.

**Wamtechnik Sp. z o.o.** ul. Techniczna 2 bud. H 05-500 Piaseczno  
Tel. +48 22 701 26 00, [office@wamtechnik.pl](mailto:office@wamtechnik.pl), [www.wamtechnik.pl](http://www.wamtechnik.pl)