



SBL 41-12HR



Nominal voltage	12 V
Nominal capacity	964 W / 10min to 1,67 V/cell
	33 Ah @ C20 to 1,75 V/cell
Technology	AGM (Absorbent Glass Mat)
	VRLA (Valve Regulated Lead Acid)
Weight	~ 10,2 kg
Design life time	15 years (standby use)
	Very Long Life acc. Eurobat
Internal resistance	~ 9 mΩ (full charged)

Operating temperature range	Discharge -20°C ~ +60°C
	Charge 0°C ~ +50°C
	Storage -20°C ~ +60°C
Max. discharge current	330 A (5 sec)
Short circuit current	930 A
Max. charging current	10 A
Charging voltage	Standby use 13,6 ~ 13,8 VDC
	Cycle use 14,6 ~ 14,8 VDC
Self discharge	Monthly is less than 3% at 25°C
Container material	ABS UL94HB (optional UL94-V0)

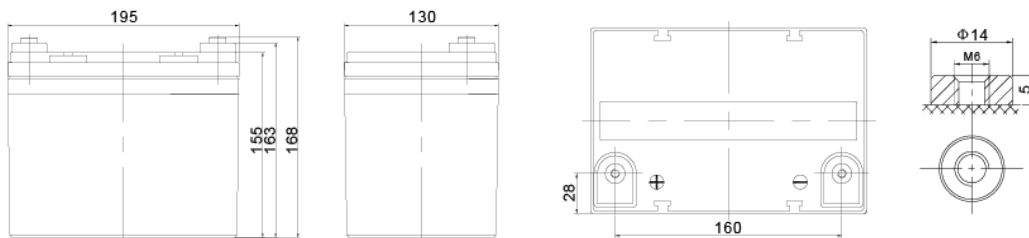

Length	195 ± 2 mm
Width	130 ± 2 mm
Height	155 ± 2 mm
Total height	168 ± 2 mm
Terminal	Internal thread M6 (breaking torque 8-10 Nm)

CONSTANT CURRENT DISCHARGE CHARACTERISTICS (A at 25°C)

Napięcie/Czas	5 MIN	8 MIN	10 MIN	15 MIN	20 MIN	30 MIN	60 MIN	90 MIN
1.60 V	124,90	103,40	90,60	69,12	56,28	41,49	24,01	17,23
1.67 V	113,30	94,82	83,74	64,46	52,91	39,26	22,90	16,53
1.70 V	108,50	91,15	80,72	62,50	51,42	38,31	22,45	16,21
1.75 V	100,20	84,90	75,68	59,12	48,85	36,69	21,67	15,70
1.80 V	91,81	78,63	70,63	55,95	46,55	35,14	20,89	15,19
1.85 V	78,80	66,98	59,84	48,11	40,41	31,08	18,87	13,85

CONSTANT POWER DISCHARGE CHARACTERISTICS (W/cell at 25°C)

Napięcie/Czas	5 MIN	8 MIN	10 MIN	15 MIN	20 MIN	30 MIN	60 MIN	90 MIN
1.60 V	229,50	192,60	170,40	131,80	108,20	80,61	45,09	32,61
1.67 V	213,60	180,70	160,80	125,00	103,20	77,30	43,40	31,52
1.70 V	206,60	175,20	156,30	122,10	101,00	75,74	42,68	31,08
1.75 V	193,90	165,60	148,50	116,80	96,96	73,24	41,51	30,25
1.80 V	180,40	155,40	140,20	111,60	93,31	70,68	40,28	29,42
1.85 V	157,20	134,30	120,40	97,03	81,76	63,04	36,63	27,06

SBL 41-12HR



EFFECT OF TEMPERATURE ON LONG TERM LIFE

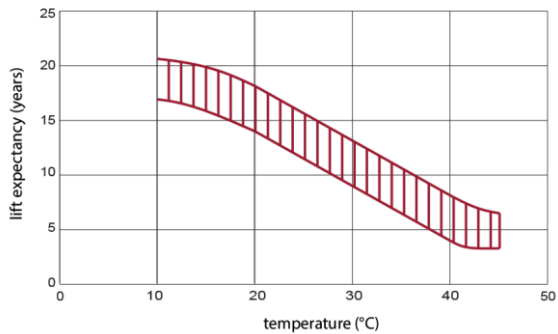

CHARGE CHARACTERISTIC CURVE FOR STANDBY USE

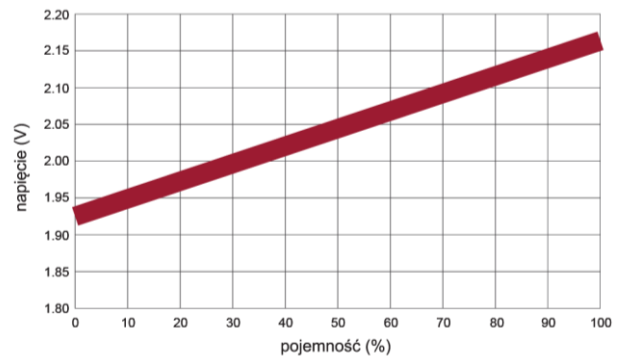

DISCHARGE CHARACTERISTICS CURVE

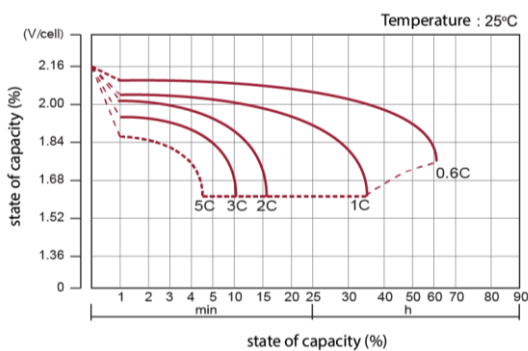

CHARGE CHARACTERISTIC CURVE FOR CYCLE USE

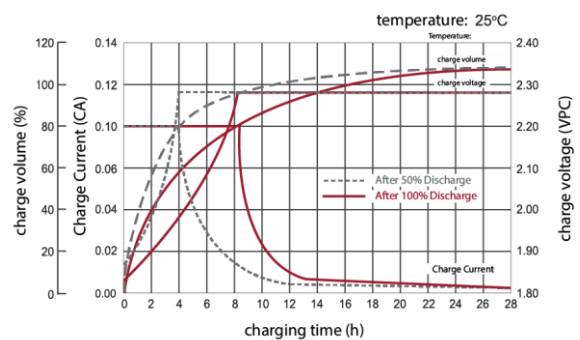

RELATIONSHIP BETWEEN CHARGING VOLTAGE AND TEMPERATURE

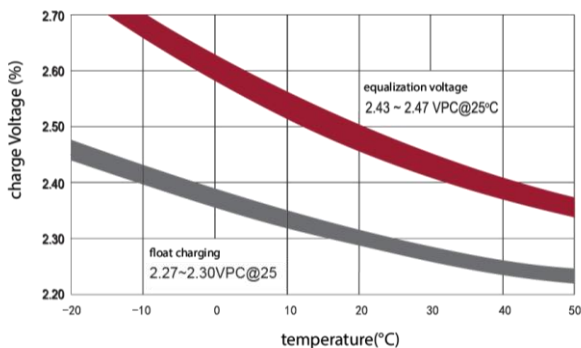

STORAGE CHARACTERISTICS

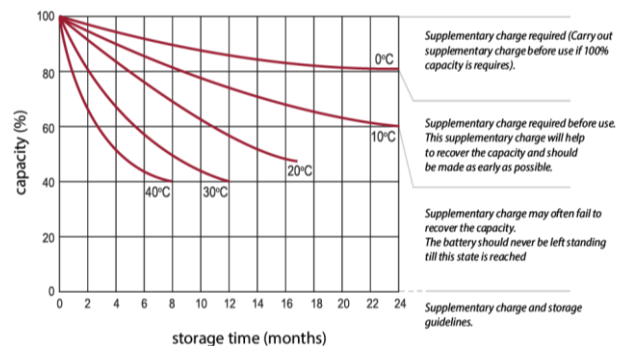

Standards met:

PN-EN 60896-21:2007 • PN-EN 60896-22:2007 • PN-EN 61056-1:2013 • PN-EN 61056-2:2013 • PN-E-83016:1999

Batteries manufactured in compliance with: ISO 9001 • ISO 14001

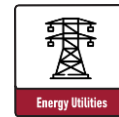
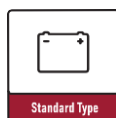

All data contained in this document, are subject to change. Wamtechnik Sp. z o.o. reserves the right to change them without prior notice.

Wamtechnik Sp. z o.o. ul. Techniczna 2 bud. H 05-500 Piaseczno
Tel. +48 22 701 26 00, office@wamtechnik.pl, www.wamtechnik.pl

WAMTECHNIK
ENERGY FOR IDEAS