



# SB 7-6



|                     |                                  |
|---------------------|----------------------------------|
| Nominal voltage     | 6 V                              |
| Nominal capacity    | 8 Ah @ C20 to 1,75 V/cell        |
| Technology          | AGM (Absorbent Glass Mat)        |
|                     | VRLA (Valve Regulated Lead Acid) |
| Weight              | ~ 1,1 kg                         |
| Design life time    | 6-9 years (standby use)          |
|                     | General Purpose wg Eurobat       |
| Internal resistance | ~ 14,5 mΩ (full charged)         |

|                             |                                 |
|-----------------------------|---------------------------------|
| Operating temperature range | Discharge -20°C ~ +60°C         |
|                             | Charge 0°C ~ +50°C              |
|                             | Storage -20°C ~ +60°C           |
| Max. discharge current      | 80 A (5 sec)                    |
| Short circuit current       | 400 A                           |
| Max. charging current       | 2,40 A                          |
| Charging voltage            | Standby use 6,85 ~ 6,94 VDC     |
|                             | Cycle use 7,30 ~ 7,40 VDC       |
| Self discharge              | Monthly is less than 3% at 25°C |
| Container material          | ABS UL94HB (optional UL94-V0)   |

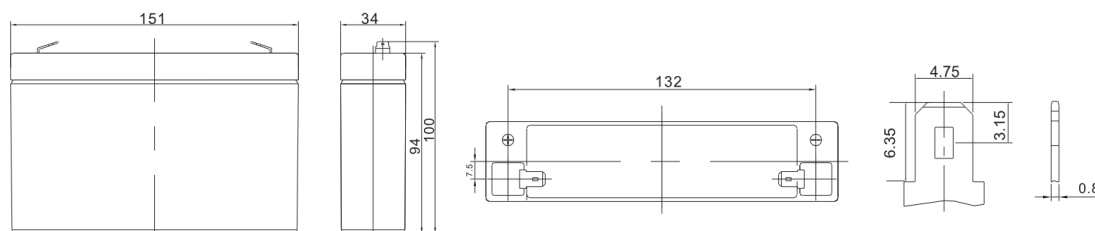

|                |                |
|----------------|----------------|
| Length         | 151 ±1,5 mm    |
| Width          | 34 ±1,5 mm     |
| Height         | 94 ±1,5 mm     |
| Total height   | 100 ±1,5 mm    |
| Terminal types | fast-on 4,8 mm |

## CONSTANT CURRENT DISCHARGE CHARACTERISTICS (A at 25°C)

| Napięcie / Czas | 5MIN  | 10MIN | 15MIN | 30MIN | 1H    | 2H    | 3H    | 4H    | 5H    | 8H    | 10H   | 20H   |
|-----------------|-------|-------|-------|-------|-------|-------|-------|-------|-------|-------|-------|-------|
| 1.60 V          | 30.35 | 21.45 | 15.51 | 8.907 | 4.888 | 3.001 | 2.256 | 1.821 | 1.509 | 0.971 | 0.789 | 0.417 |
| 1.65 V          | 28.23 | 20.27 | 14.83 | 8.551 | 4.720 | 2.905 | 2.186 | 1.772 | 1.470 | 0.960 | 0.779 | 0.410 |
| 1.70 V          | 25.47 | 18.66 | 13.89 | 8.173 | 4.567 | 2.810 | 2.127 | 1.724 | 1.432 | 0.946 | 0.767 | 0.405 |
| 1.75 V          | 22.82 | 17.08 | 12.92 | 7.812 | 4.400 | 2.711 | 2.063 | 1.680 | 1.396 | 0.932 | 0.757 | 0.400 |
| 1.80 V          | 20.03 | 15.46 | 11.93 | 7.466 | 4.231 | 2.614 | 2.000 | 1.632 | 1.360 | 0.917 | 0.748 | 0.396 |
| 1.85 V          | 15.90 | 12.64 | 9.901 | 6.430 | 3.795 | 2.395 | 1.849 | 1.516 | 1.268 | 0.860 | 0.704 | 0.376 |

## CONSTANT POWER DISCHARGE CHARACTERISTICS (W/cell at 25°C)

| Napięcie / Czas | 5MIN  | 10MIN | 15MIN | 30MIN | 1H    | 2H    | 3H    | 4H    | 5H    | 8H    | 10H   | 20H   |
|-----------------|-------|-------|-------|-------|-------|-------|-------|-------|-------|-------|-------|-------|
| 1.60 V          | 50.32 | 36.46 | 27.11 | 16.18 | 9.185 | 5.688 | 4.309 | 3.497 | 2.909 | 1.897 | 1.551 | 0.820 |
| 1.65 V          | 47.33 | 35.12 | 26.30 | 15.69 | 8.921 | 5.533 | 4.193 | 3.415 | 2.844 | 1.879 | 1.534 | 0.808 |
| 1.70 V          | 43.68 | 32.93 | 25.00 | 15.15 | 8.685 | 5.380 | 4.098 | 3.334 | 2.780 | 1.855 | 1.513 | 0.800 |
| 1.75 V          | 40.00 | 30.68 | 23.61 | 14.63 | 8.418 | 5.216 | 3.992 | 3.261 | 2.719 | 1.833 | 1.495 | 0.791 |
| 1.80 V          | 35.87 | 28.26 | 22.10 | 14.12 | 8.143 | 5.055 | 3.884 | 3.179 | 2.658 | 1.806 | 1.477 | 0.784 |
| 1.85 V          | 29.07 | 23.51 | 18.60 | 12.29 | 7.348 | 4.657 | 3.607 | 2.966 | 2.487 | 1.699 | 1.393 | 0.745 |

EFFECT OF TEMPERATURE ON LONG TERM LIFE

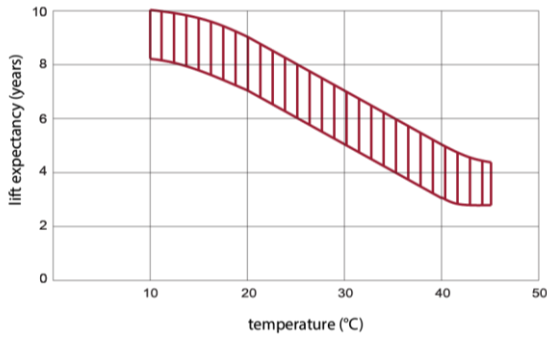

CYCLE LIFE IN RELATION TO DEPTH OF DISCHARGE

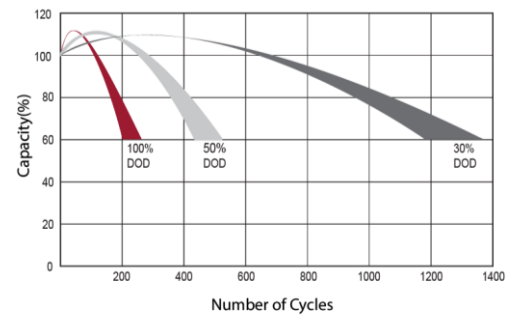

DISCHARGE CHARACTERISTICS CURVE



CHARGE CHARACTERISTIC CURVE FOR CYCLE USE

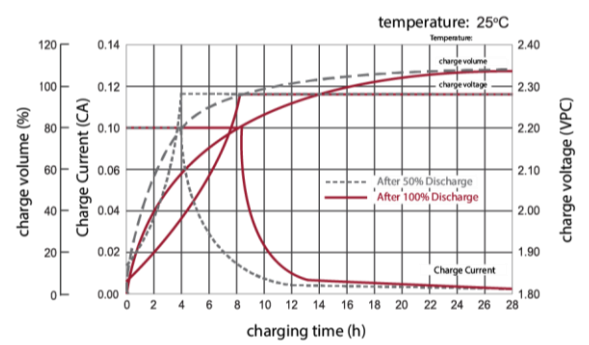

RELATIONSHIP BETWEEN CHARGING VOLTAGE AND TEMPERATURE

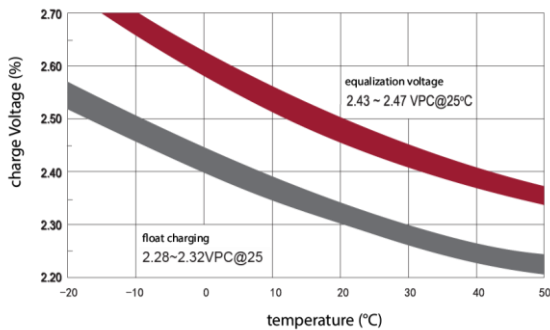

STORAGE CHARACTERISTICS



**Standards met:**

PN-EN 60896-21:2007 • PN-EN 60896-22:2007 • PN-EN 61056-1:2013 • PN-EN 61056-2:2013 • PN-E-83016:1999

**Batteries manufactured in compliance with: ISO 9001 • ISO 14001**

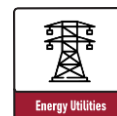
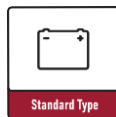

All data contained in this document, are subject to change. Wamtechnik Sp. z o.o. reserves the right to change them without prior notice.