



SBL 160-12i



Nominal voltage	12 V
Nominal capacity	160 Ah @ C20 to 1,75 V/cell
	150 Ah @ C10 to 1,80 V/cell
Technology	AGM (Absorbent Glass Mat)
	VRLA (Valve Regulated Lead Acid)
Weight	~ 44,5 kg
Design life time	12 years (standby use)
	Long Life acc. Eurobat
Internal resistance	~ 4,8 mΩ (full charged)

Operating temperature range	Discharge -20°C ~ +60°C
	Charge 0°C ~ +50°C
	Storage -20°C ~ +60°C
Max. discharge current	1500 A (5 sec)
Short circuit current	2700 A
Max. charging current	45 A
Charging voltage	Standby use 13,6 ~ 13,8 VDC
	Cycle use 14,6 ~ 14,8 VDC
Self discharge	Monthly is less than 3% at 25°C
Container material	ABS UL94HB (optional UL94-V0)

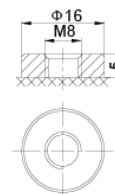
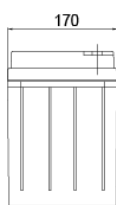
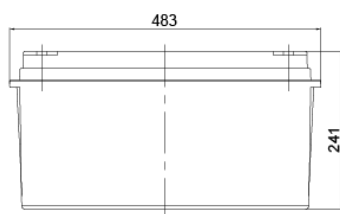

Length	483 ±2 mm
Width	170 ±2 mm
Height	241 ±2 mm
Total height	241 ±2 mm
Internal thread M8 (breaking torque 10-12 Nm)	

CONSTANT CURRENT DISCHARGE CHARACTERISTICS (A at 25°C)

Voltage/Time	10 MIN	15 MIN	30 MIN	60 MIN	2 H	3 H	4 H	5 H	8 H	10 H	20 H
1.60 V	322,9	261,6	161,0	91,6	54,6	42,3	33,3	28,3	19,0	15,8	8,28
1.65 V	305,1	250,1	154,6	88,5	52,9	41,0	32,4	27,6	18,8	15,6	8,21
1.70 V	280,9	234,2	147,7	85,6	51,1	39,9	31,5	26,8	18,5	15,4	8,13
1.75 V	257,1	218,0	141,2	82,5	49,3	38,7	30,7	26,2	18,3	15,2	8,00
1.80 V	232,8	201,3	135,0	79,3	47,6	37,5	29,8	25,5	17,9	15,0	7,87
1.85 V	190,2	167,0	116,2	71,2	43,6	34,7	27,7	23,8	16,8	14,1	7,65

CONSTANT POWER DISCHARGE CHARACTERISTICS (W/cell at 25°C)

Voltage/Time	10 MIN	15 MIN	30 MIN	60 MIN	2 H	3 H	4 H	5 H	8 H	10 H	20 H
1.60 V	572,1	463,0	292,4	175,3	103,5	80,8	65,0	55,1	37,3	31,9	16,39
1.65 V	569,8	460,4	288,0	173,8	105,6	79,0	64,5	54,7	37,0	31,7	16,29
1.70 V	553,0	448,0	281,0	170,1	103,9	77,8	63,5	54,0	36,6	31,3	16,13
1.75 V	532,3	432,8	272,5	165,2	101,6	76,2	62,3	53,0	36,0	30,8	15,91
1.80 V	501,9	410,6	260,4	158,4	98,4	74,0	60,7	51,7	35,1	30,1	15,62
1.85 V	460,2	380,2	243,8	149,7	94,1	71,0	58,4	49,9	34,0	29,2	15,23

EFFECT OF TEMPERATURE ON LONG TERM LIFE

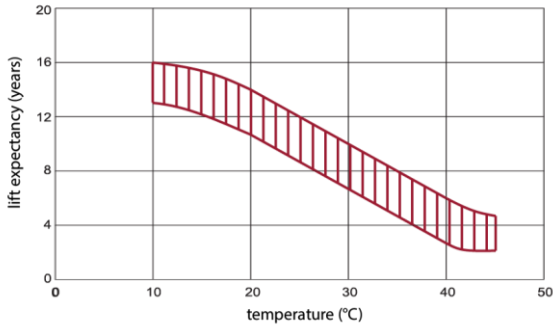

CYCLE LIFE IN RELATION TO DEPTH OF DISCHARGE

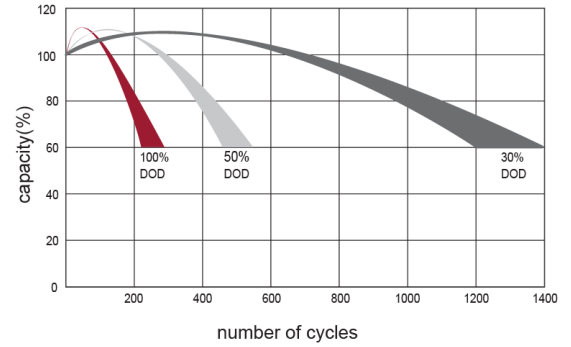

DISCHARGE CHARACTERISTICS CURVE



CHARGE CHARACTERISTIC CURVE FOR CYCLE USE

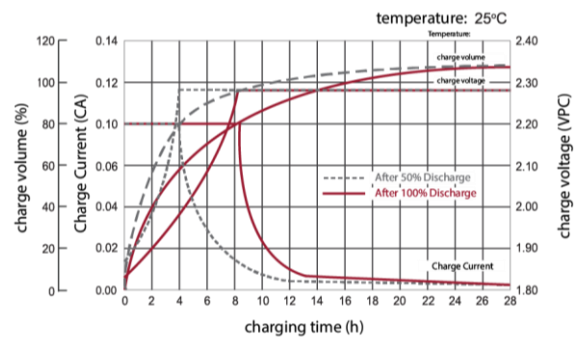

RELATIONSHIP BETWEEN CHARGING VOLTAGE AND TEMPERATURE



STORAGE CHARACTERISTICS



Standards met:

PN-EN 60896-21:2007 • PN-EN 60896-22:2007 • PN-EN 61056-1:2013 • PN-EN 61056-2:2013 • PN-E-83016:1999

Batteries manufactured in compliance with: ISO 9001 • ISO 14001

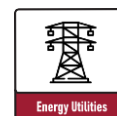
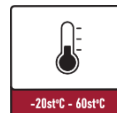
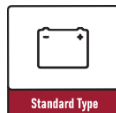

All data contained in this document, are subject to change. Wamtechnik Sp. z o.o. reserves the right to change them without prior notice.