



SBCG 33-12i



Nominal voltage	12 V
Nominal capacity	33 Ah @ C20 to 1,75 V/cell
Technology	Electrolyte – GEL VRLA (Valve Regulated Lead Acid)
Weight	~ 9,8 kg
Design life time	15 years (standby use) Very Long Life wg Eurobat
Internal resistance	~ 13 mΩ (full charged)

Operating temperature range	Discharge -40°C ~ +60°C
	Charge -20°C ~ +50°C
	Storage -40°C ~ +60°C
Maximum discharge current	330 A (5 sec)
Maximum charging current	6,6 A
Charging voltage	Standby use 13,6 ~ 13,8 VDC
	Cycle use 14,2 ~ 14,4 VDC
Self discharge	Monthly is less than 2% at 25°C
Container material	ABS UL94HB (optional UL94-V0)

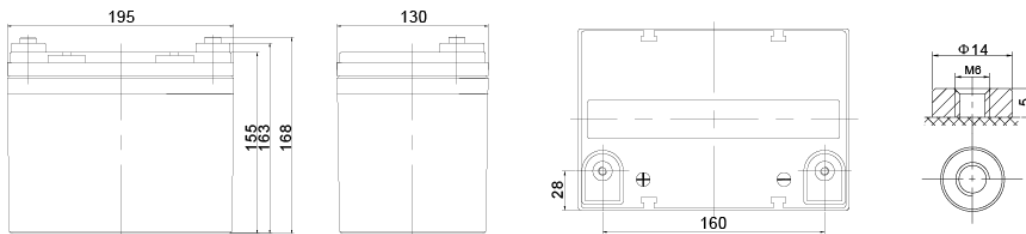

Length	195 ±2 mm
Width	130 ±2 mm
Height	155 ±2 mm
Total height	168 ±2 mm
Terminal types	Internal thread M6 (breaking torque 8-10Nm)

CONSTANT CURRENT DISCHARGE CHARACTERISTICS (A at 25°C)

Voltage/Time	10 MIN	15 MIN	30 MIN	60 MIN	2 H	3 H	4 H	5 H	8 H	10 H	20 H
1.60V	54,0	43,8	28,7	17,9	10,90	8,21	6,55	5,49	3,71	3,06	1,72
1.65V	51,1	41,9	27,6	17,3	10,60	7,96	6,37	5,35	3,67	3,03	1,69
1.70V	47,0	39,2	26,4	16,7	10,30	7,74	6,20	5,21	3,62	2,98	1,67
1.75V	43,0	36,5	25,2	16,1	9,89	7,51	6,04	5,08	3,57	2,94	1,65
1.80V	38,9	33,7	24,1	15,5	9,54	7,28	5,87	4,95	3,51	2,90	1,63
1.85V	31,8	28,0	20,8	13,9	8,74	6,73	5,45	4,62	3,29	2,73	1,55

CONSTANT POWER DISCHARGE CHARACTERISTICS (W/cell at 25°C)

Voltage/Time	10 MIN	15 MIN	30 MIN	60 MIN	2 H	3 H	4 H	5 H	8 H	10 H	20 H
1.60V	104,4	87,0	59,3	38,3	23,6	17,8	14,3	12,0	8,24	6,84	3,84
1.65V	99,3	83,7	57,5	37,2	22,9	17,4	14,0	11,8	8,15	6,76	3,79
1.70V	94,2	80,3	55,6	36,2	22,3	16,9	13,6	11,5	8,06	6,68	3,75
1.75V	87,8	75,8	53,7	35,1	21,6	16,5	13,3	11,3	7,96	6,60	3,71
1.80V	80,9	71,0	58,1	33,9	21,0	16,1	13,0	11,0	7,85	6,52	3,67
1.85V	67,3	59,7	45,1	30,6	19,3	14,9	12,1	10,3	7,38	6,15	3,49

EFFECT OF TEMPERATURE ON LONG TERM LIFE

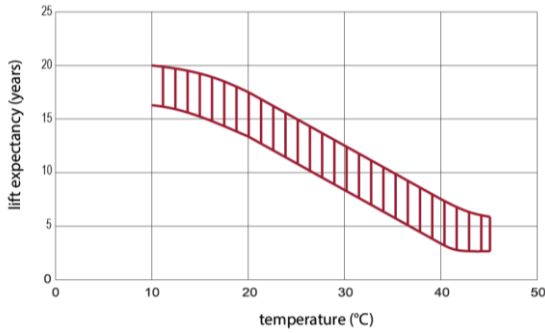

CYCLE LIFE IN RELATION TO DEPTH OF DISCHARGE

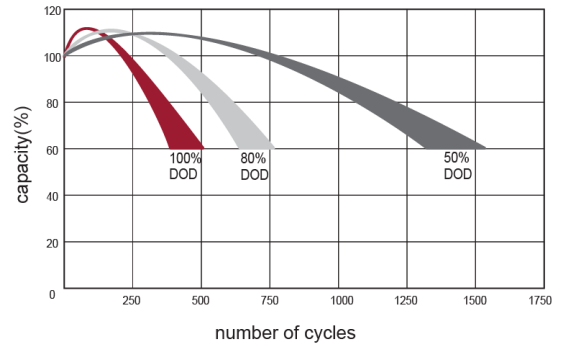

DISCHARGE CHARACTERISTICS CURVE

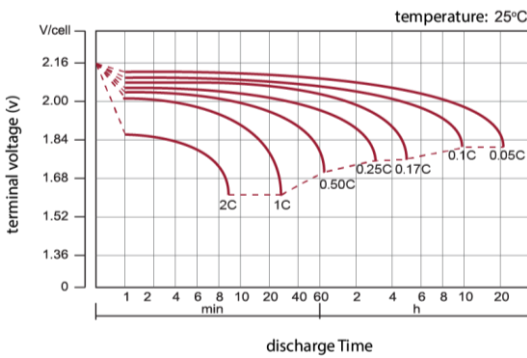

CHARGE CHARACTERISTIC CURVE FOR CYCLE USE

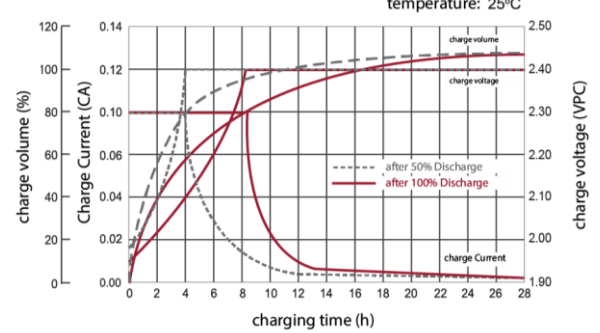

RELATIONSHIP BETWEEN CHARGING VOLTAGE AND TEMPERATURE

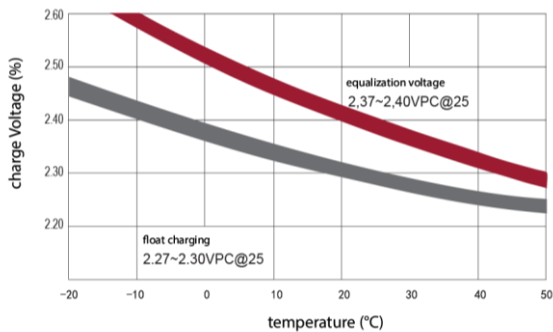

STORAGE CHARACTERISTICS

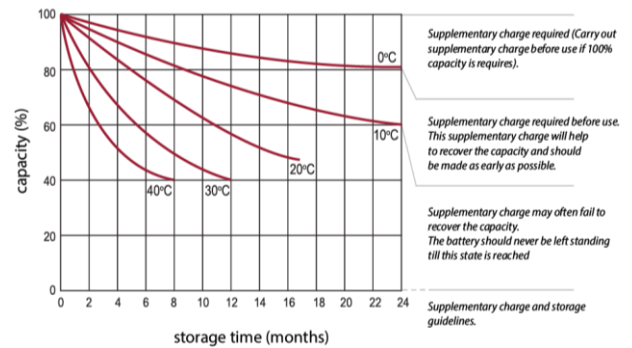

Standards met:

PN-EN 60896-21:2007 • PN-EN 60896-22:2007 • PN-EN 61056-1:2013 • PN-EN 61056-2:2013 • PN-E-83016:1999

Batteries manufactured in compliance with: ISO 9001 • ISO 14001

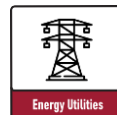
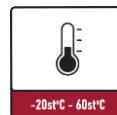
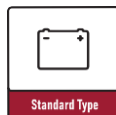

All data contained in this document, are subject to change. Wamtechnik Sp. z o.o. reserves the right to change them without prior notice..