

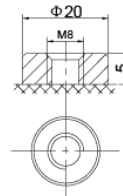

SBL 500-2i

Nominal voltage	2 V	Operating temperature range	Discharge -20°C ~ +60°C Charge 0°C ~ +50°C Storage -20°C ~ +60°C
Nominal capacity	500 Ah @ C10 to 1,80 V/cell	Max. discharge current	2000 (5 sec)
Technology	AGM (Absorbent Glass Mat) VRLA (Valve Regulated Lead Acid)	Short circuit current	4210 A
Weight	~ 25,5 kg	Max. charging current	100 A
Design life time	20 years (standby use) Very Long Life acc. Eurobat	Charging voltage	Standby use 2,27 ~ 2,30 VDC Cycle use 2,43 ~ 2,47 VDC
Internal resistance	~ 0,60 mΩ (full charged)	Self discharge	Monthly is less than 3% at 25°C
		Container material	ABS UL94HB (optional UL94-V0)

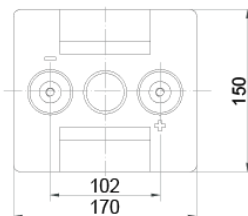
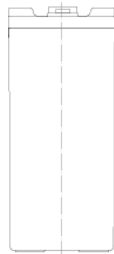
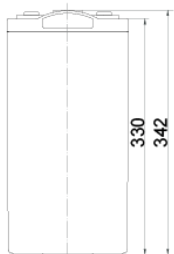

Length	196 ±2 mm
Width	171 ±2 mm
Height	330 ±2 mm
Total height	342 ±2 mm
Terminal type	Internal thread M8 (breaking torque 10-12 Nm)

CONSTANT CURRENT DISCHARGE CHARACTERISTICS (A at 25°C)

Voltage/Time	10 MIN	15 MIN	30 MIN	1 H	2 H	3 H	5 H	8 H	10 H	20 H
1.60V	786,4	629,4	428,4	283,0	180,5	134,4	90,30	62,38	52,25	27,43
1.65V	751,2	606,8	418,3	278,7	177,8	132,9	89,55	61,88	51,75	27,17
1.70V	701,0	576,7	403,3	271,5	174,8	130,4	88,06	61,13	51,50	27,04
1.75V	623,1	526,6	380,8	260,2	170,6	128,0	86,81	60,38	50,75	26,64
1.80V	527,6	471,4	355,7	250,2	164,8	125,2	85,07	59,38	50,00	26,25
1.85V	429,6	388,7	305,6	223,3	150,4	115,1	78,85	55,39	46,75	24,54

CONSTANT POWER DISCHARGE CHARACTERISTICS (W/cell at 25°C)

Voltage/Time	10 MIN	15 MIN	30 MIN	1 H	2 H	3 H	5 H	8 H	10 H	20 H
1.60V	1337	1101	779,1	530,5	342,6	257,2	174,9	122,3	103,3	54,21
1.65V	1304	1078	769,0	524,7	339,6	255,7	173,6	121,8	102,5	53,81
1.70V	1236	1036	746,5	514,7	333,9	251,5	172,1	120,5	101,8	53,42
1.75V	1121	962,9	711,4	497,8	326,7	247,3	169,4	119,3	100,8	52,89
1.80V	964,8	872,6	673,8	482,0	319,7	243,0	166,4	117,5	99,25	52,11
1.85V	799,0	732,2	583,7	430,8	292,3	224,4	155,0	110,0	93,25	48,96

EFFECT OF TEMPERATURE ON LONG TERM LIFE

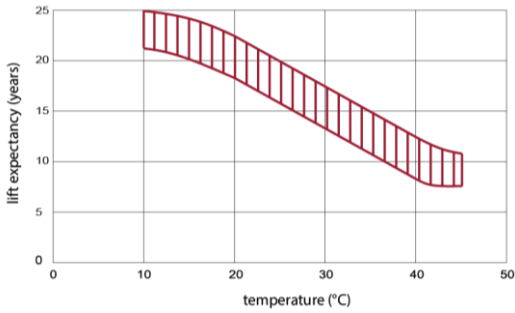

CYCLE LIFE IN RELATION TO DEPTH OF DISCHARGE

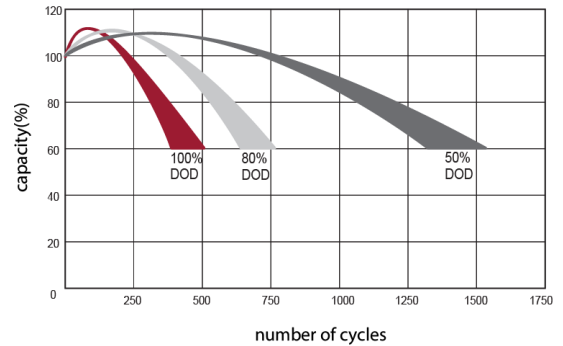

DISCHARGE CHARACTERISTICS CURVE

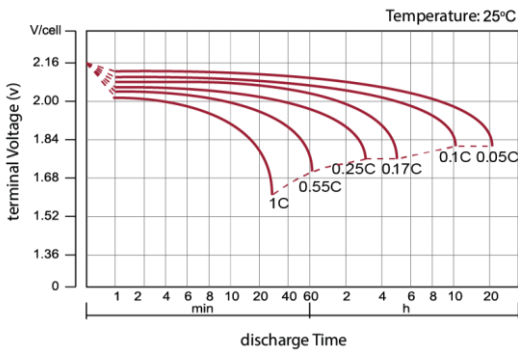

CHARGE CHARACTERISTIC CURVE FOR CYCLE USE

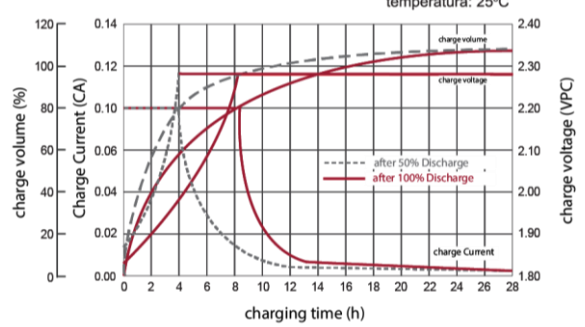

RELATIONSHIP BETWEEN CHARGING VOLTAGE AND TEMPERATURE

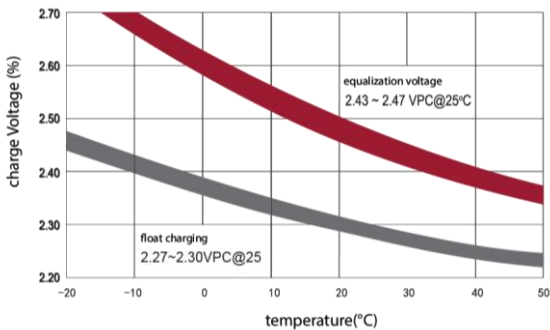

STORAGE CHARACTERISTICS

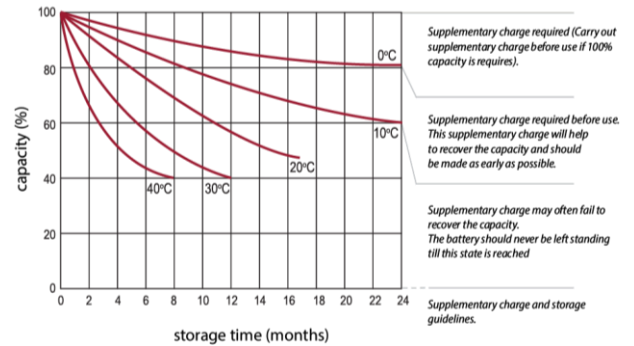

Standards met:

PN-EN 60896-21:2007 • PN-EN 60896-22:2007 • PN-EN 61056-1:2013 • PN-EN 61056-2:2013 • PN-E-83016:1999

Batteries manufactured in compliance with: ISO 9001 • ISO 14001

All data contained in this document, are subject to change. Wamtechnik Sp. z o.o. reserves the right to change them without prior notice.