



# SBL 41-12HR



Nominal voltage	12 V
Nominal capacity	930 W / 10min to 1,67 V/cell 33 Ah @ C20 to 1,75 V/cell
Technology	AGM (Absorbent Glass Mat) VRLA (Valve Regulated Lead Acid)
Weight	~ 10,2 kg
Design life time	15 years (standby use) Very Long Life acc. Eurobat
Internal resistance	~ 9 mΩ (full charged)

Operating temperature range	Discharge -20°C ~ +60°C
	Charge 0°C ~ +50°C
	Storage -20°C ~ +60°C
Max. discharge current	330 A (5 sec)
Short circuit current	930 A
Max. charging current	10 A
Charging voltage	Standby use 13,6 ~ 13,8 VDC
	Cycle use 14,6 ~ 14,8 VDC
Self discharge	Monthly is less than 3% at 25°C
Container material	ABS UL94HB (optional UL94-V0)

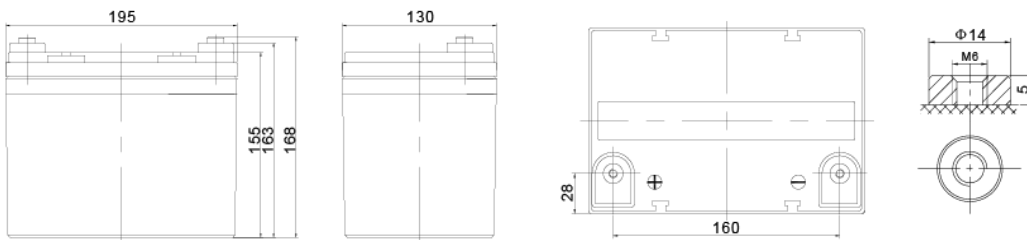

Length	195 ± 2 mm
Width	130 ± 2 mm
Height	155 ± 2 mm
Total height	168 ± 2 mm
Terminal	Internal thread M6 (breaking torque 8-10 Nm)

## CONSTANT CURRENT DISCHARGE CHARACTERISTICS (A at 25°C)

Napięcie/Czas	5 MIN	8 MIN	10 MIN	15 MIN	20 MIN	30 MIN	60 MIN	90 MIN
1.60 V	124,9	103,4	90,6	69,1	56,3	41,5	24,0	17,2
1.67 V	113,3	94,8	83,7	64,5	52,9	39,3	22,9	16,5
1.70 V	108,5	91,1	80,7	62,5	51,4	38,3	22,4	16,2
1.75 V	100,2	84,9	75,7	59,1	48,9	36,7	21,7	15,7
1.80 V	91,8	78,6	70,6	55,9	46,6	35,1	20,9	15,2
1.85 V	78,8	67,0	59,8	48,1	40,4	31,1	18,9	13,8

## CONSTANT POWER DISCHARGE CHARACTERISTICS (W/cell at 25°C)

Napięcie/Czas	5 MIN	8 MIN	10 MIN	15 MIN	20 MIN	30 MIN	60 MIN	90 MIN
1.60 V	229,5	192,6	170,4	131,8	108,2	80,6	45,1	32,6
1.67 V	213,6	180,7	160,8	125,0	103,2	77,3	43,4	31,5
1.70 V	206,6	175,2	156,3	122,1	101,0	75,7	42,7	31,1
1.75 V	193,9	165,6	148,5	116,8	97,0	73,2	41,5	30,2
1.80 V	180,4	155,4	140,2	111,6	93,3	70,7	40,3	29,4
1.85 V	157,2	134,3	120,4	97,0	81,8	63,0	36,6	27,1

EFFECT OF TEMPERATURE ON LONG TERM LIFE

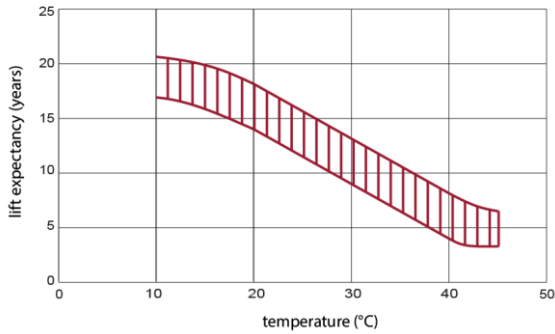

CHARGE CHARACTERISTIC CURVE FOR STANDBY USE

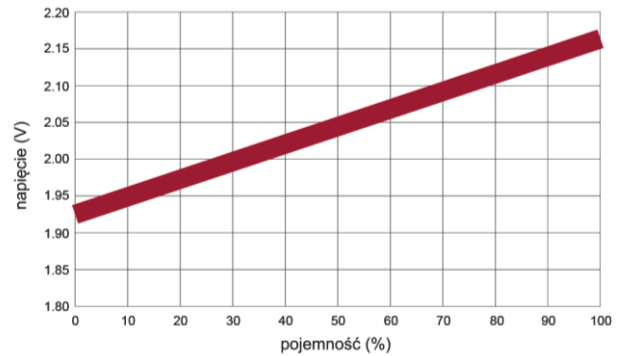

DISCHARGE CHARACTERISTICS CURVE

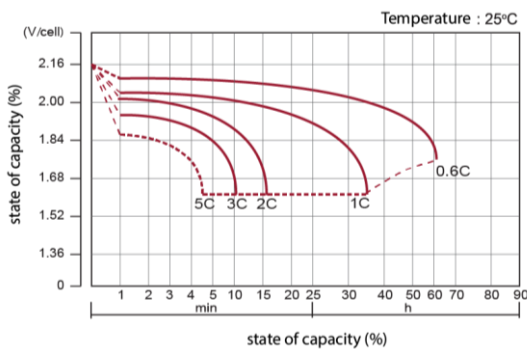

CHARGE CHARACTERISTIC CURVE FOR CYCLE USE

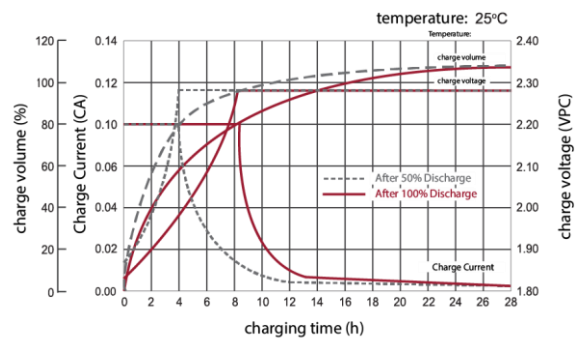

RELATIONSHIP BETWEEN CHARGING VOLTAGE AND TEMPERATURE

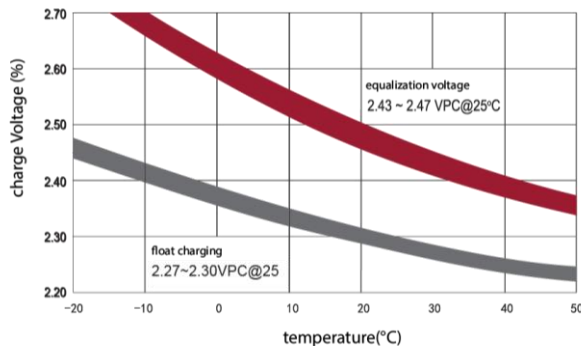

STORAGE CHARACTERISTICS

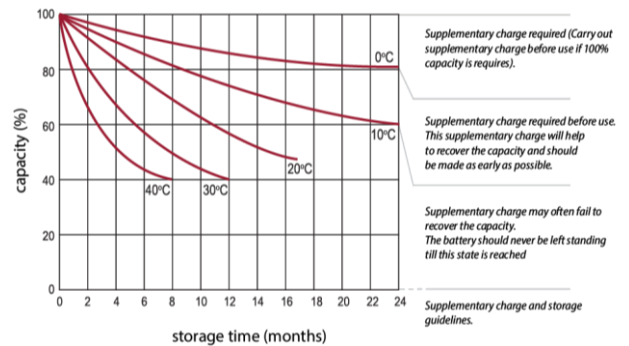

**Standards met:**

PN-EN 60896-21:2007 • PN-EN 60896-22:2007 • PN-EN 61056-1:2013 • PN-EN 61056-2:2013 • PN-E-83016:1999

Batteries manufactured in compliance with: ISO 9001 • ISO 14001

AGM Technology	VRLA	Standard Type	-20st°C - 60st°C	Recyclable	> 12 Years
High Rate Type	UPS	Emergency Lighting	Security Systems	Energy Utilities	DC Power Supply

All data contained in this document, are subject to change. Wamtechnik Sp. z o.o. reserves the right to change them without prior notice.