

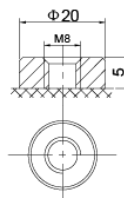

SBL 400-2i

Nominal voltage	2 V
Nominal capacity	400 Ah @ C10 dla rozładowania do 1,80 V/celę
Technology	AGM (Absorbent Glass Mat) VRLA (Valve Regulated Lead Acid)
Weight	~ 19 kg
Design life time	20 years (standby use) Very Long Life acc. Eurobat
Internal resistance	~ 0,68 mΩ (full charged)

Operating temperature range	Discharge -20°C ~ +60°C
	Charge 0°C ~ +50°C
	Storage -20°C ~ +60°C
Max. discharge current	2000 (5 sec)
Short circuit current	3400 A
Max. charging current	80 A
Charging voltage	Standby use 2,27 ~ 2,30 VDC
	Cycle use 2,43 ~ 2,47 VDC
Self discharge	Monthly is less than 3% at 25°C
Container material	ABS UL94HB (optional UL94-V0)

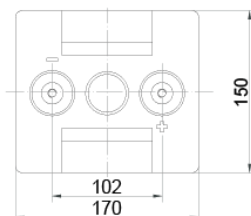
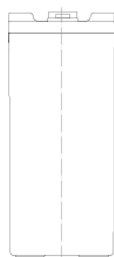
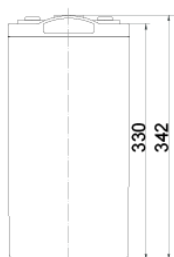

Length	170 ±2 mm
Width	150 ±2 mm
Height	330 ±2 mm
Total height	342 ±2 mm
Terminal type	Internal thread M8 (breaking torque 10-12 Nm)

CONSTANT CURRENT DISCHARGE CHARACTERISTICS (A at 25°C)

Napięcie/Czas	10 MIN	15 MIN	30 MIN	60 MIN	2 H	3 H	4 H	5 H	8 H	10 H	20 H
1.60V	332,2	273,6	183,4	111,8	66,9	46,2	37,9	31,0	21,4	18,1	11,0
1.65V	316,1	268,0	181,8	111,3	66,4	46,1	37,7	30,8	21,2	17,9	10,6
1.70V	304,9	263,8	180,7	110,2	65,9	45,7	37,5	30,7	21,0	17,7	10,3
1.75V	284,7	254,1	177,9	109,2	65,4	45,5	37,2	30,3	20,8	17,5	10,0
1.80V	262,7	237,0	171,7	106,6	64,2	44,3	36,3	29,7	20,5	17,4	9,4
1.85V	237,5	215,0	162,4	101,3	61,4	42,3	34,6	28,5	19,6	16,8	9,0

CONSTANT POWER DISCHARGE CHARACTERISTICS (W/cell at 25°C)

Napięcie/Czas	10 MIN	15 MIN	30 MIN	60 MIN	2 H	3 H	4 H	5 H	8 H	10 H	20 H
1.60V	632,5	527,5	359,6	231,9	142,9	108,0	86,6	72,9	50,0	41,5	23,3
1.65V	601,8	507,0	348,2	225,6	139,1	105,3	84,6	71,3	49,4	41,0	23,0
1.70V	571,1	488,1	345,4	219,3	135,2	102,7	82,6	69,7	48,8	40,5	22,7
1.75V	532,2	471,0	340,6	212,6	131,1	100,0	80,8	68,2	48,3	40,0	22,5
1.80V	493,5	440,4	329,7	207,3	127,4	97,3	78,7	66,7	47,6	39,5	22,3
1.85V	451,3	401,0	312,6	198,5	122,6	90,4	73,5	62,4	44,7	37,3	21,2

EFFECT OF TEMPERATURE ON LONG TERM LIFE

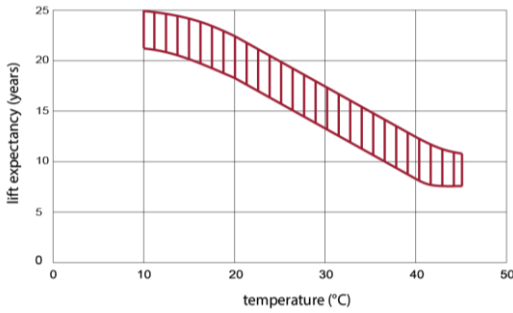

CYCLE LIFE IN RELATION TO DEPTH OF DISCHARGE

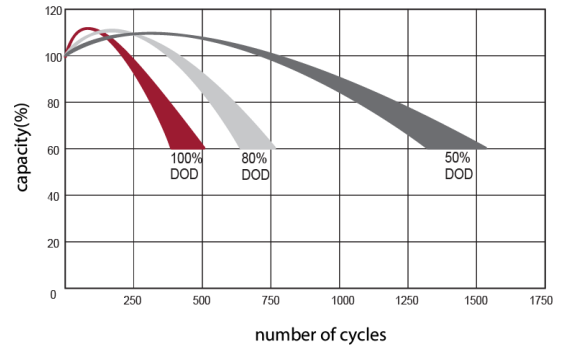

DISCHARGE CHARACTERISTICS CURVE

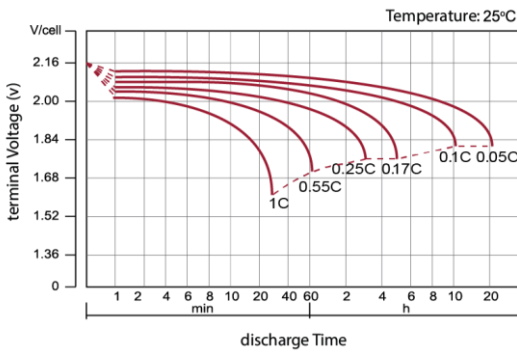

CHARGE CHARACTERISTIC CURVE FOR CYCLE USE

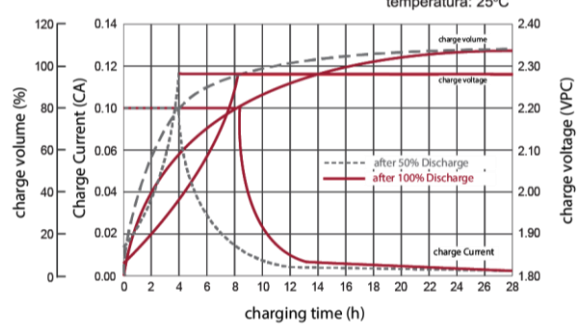

RELATIONSHIP BETWEEN CHARGING VOLTAGE AND TEMPERATURE

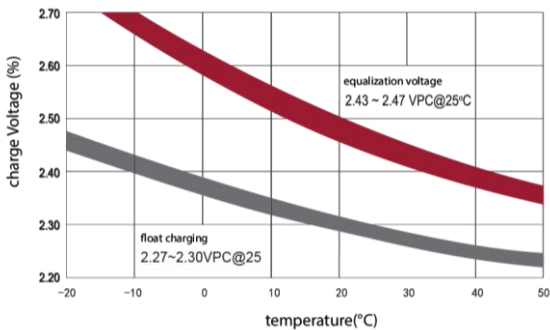

STORAGE CHARACTERISTICS

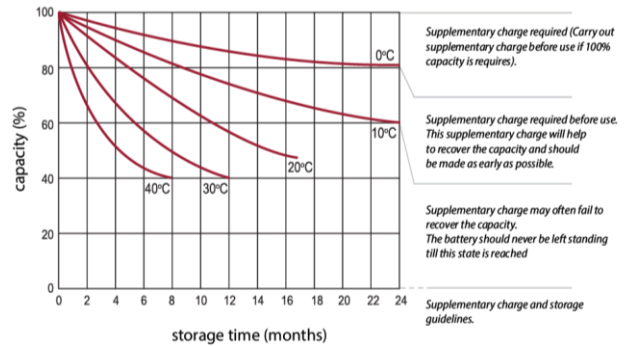

Standards met:

PN-EN 60896-21:2007 • PN-EN 60896-22:2007 • PN-EN 61056-1:2013 • PN-EN 61056-2:2013 • PN-E-83016:1999

Batteries manufactured in compliance with: ISO 9001 • ISO 14001

AGM Technology	VRLA Maintenance Free	Standard Type	-20st°C - 60st°C	Recyclable	> 12 Years Life Expect. EUROBAT
UPS	Emergency Lighting	Fire Alarm Systems	Security Systems	Energy Utilities	DC Power Supply

All data contained in this document, are subject to change. Wamtechnik Sp. z o.o. reserves the right to change them without prior notice.