

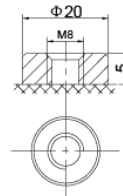

SBL 300-2i

Nominal voltage	2 V	Operating temperature range	Discharge -20°C ~ +60°C
Nominal capacity	300 Ah @ C10 to 1,80 V/cell		Charge 0°C ~ +50°C
Technology	AGM (Absorbent Glass Mat) VRLA (Valve Regulated Lead Acid)		Storage -20°C ~ +60°C
Weight	~ 16,5 kg	Max. discharge current	1500 (5 sec)
Design life time	20 years (standby use) Very Long Life acc. Eurobat	Short circuit current	2910 A
Internal resistance	~ 0,72 mΩ (full charged)	Max. charging current	60 A
		Charging voltage	Standby use 2,27 ~ 2,30 VDC Cycle use 2,43 ~ 2,47 VDC
		Self discharge	Monthly is less than 3% at 25°C
		Container material	ABS UL94HB (optional UL94-V0)

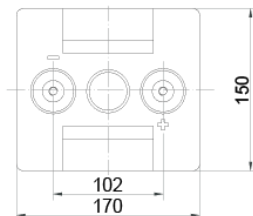
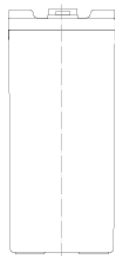
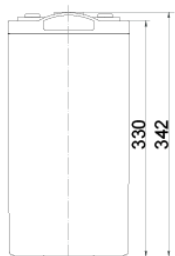

Length	170 ±2 mm
Width	150 ±2 mm
Height	330 ±2 mm
Total height	342 ±2 mm
Terminal type	Internal thread M8 (breaking torque 10-12 Nm)

CONSTANT CURRENT DISCHARGE CHARACTERISTICS (A at 25°C)

Voltage/Time	10 MIN	15 MIN	30 MIN	1 H	2 H	3 H	5 H	8 H	10 H	20 H
1.60V	471,8	377,6	257,0	169,8	108,3	80,65	54,18	37,43	31,35	16,46
1.65V	450,7	364,1	251,0	167,2	106,7	79,76	53,73	37,13	31,05	16,30
1.70V	420,6	346,0	242,0	162,9	104,9	78,27	52,83	36,68	30,90	16,22
1.75V	373,9	315,9	228,5	156,1	102,3	76,78	52,09	36,23	30,45	15,99
1.80V	316,6	282,8	213,4	150,1	98,90	75,14	51,04	35,63	30,00	15,75
1.85V	257,8	233,2	183,4	134,0	90,24	69,04	47,31	33,23	28,05	14,73

CONSTANT POWER DISCHARGE CHARACTERISTICS (W/cell at 25°C)

Voltage/Time	10 MIN	15 MIN	30 MIN	1 H	2 H	3 H	5 H	8 H	10 H	20 H
1.60V	802,0	660,5	467,4	318,3	205,6	154,3	104,9	73,35	61,95	32,52
1.65V	782,4	646,9	461,4	314,8	203,8	153,4	104,2	73,05	61,50	32,29
1.70V	741,7	621,4	447,9	308,8	200,3	150,9	103,3	72,31	61,05	32,05
1.75V	672,3	577,7	426,9	298,7	196,0	148,4	101,6	71,56	60,45	31,74
1.80V	578,9	523,6	404,3	289,2	191,8	145,8	99,85	70,51	59,55	31,26
1.85V	479,4	439,3	350,2	258,5	175,4	134,7	92,98	66,02	55,95	29,37

EFFECT OF TEMPERATURE ON LONG TERM LIFE

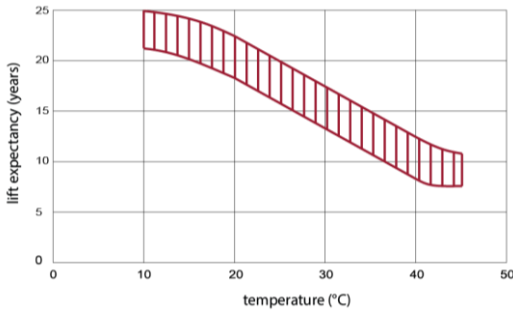

CYCLE LIFE IN RELATION TO DEPTH OF DISCHARGE

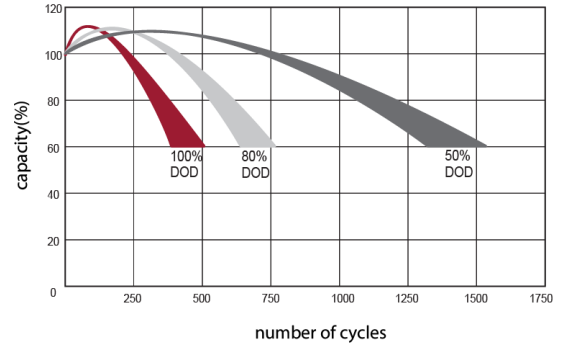

DISCHARGE CHARACTERISTICS CURVE

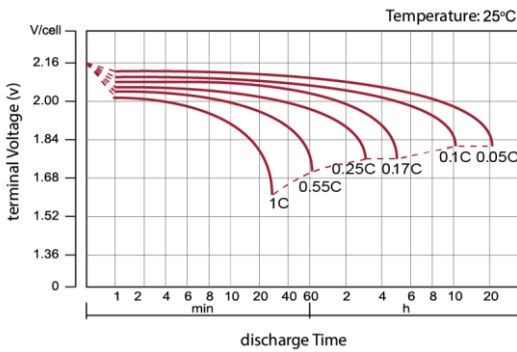

CHARGE CHARACTERISTIC CURVE FOR CYCLE USE

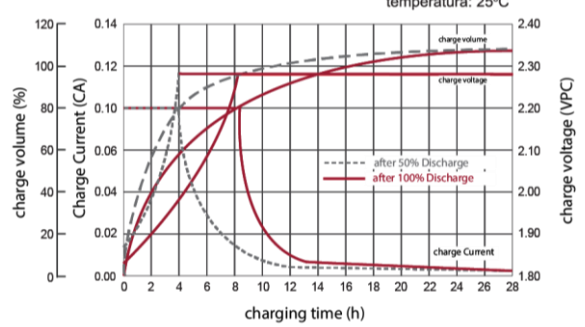

RELATIONSHIP BETWEEN CHARGING VOLTAGE AND TEMPERATURE

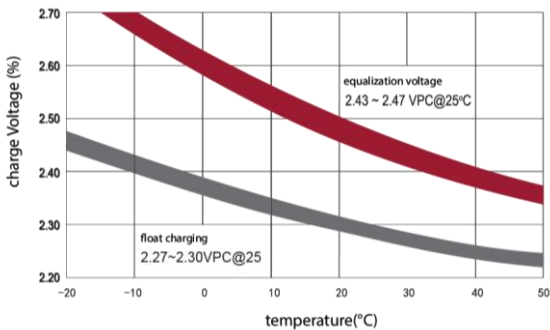

STORAGE CHARACTERISTICS

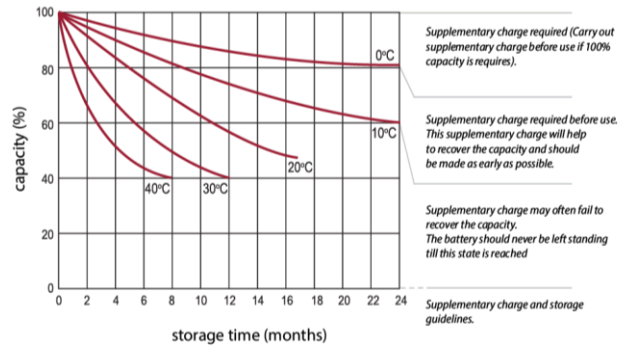

Standards met:

PN-EN 60896-21:2007 • PN-EN 60896-22:2007 • PN-EN 61056-1:2013 • PN-EN 61056-2:2013 • PN-E-83016:1999

Batteries manufactured in compliance with: ISO 9001 • ISO 14001

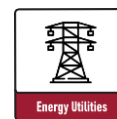
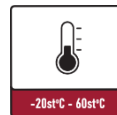
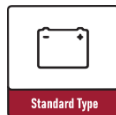

All data contained in this document, are subject to change. Wamtechnik Sp. z o.o. reserves the right to change them without prior notice.