

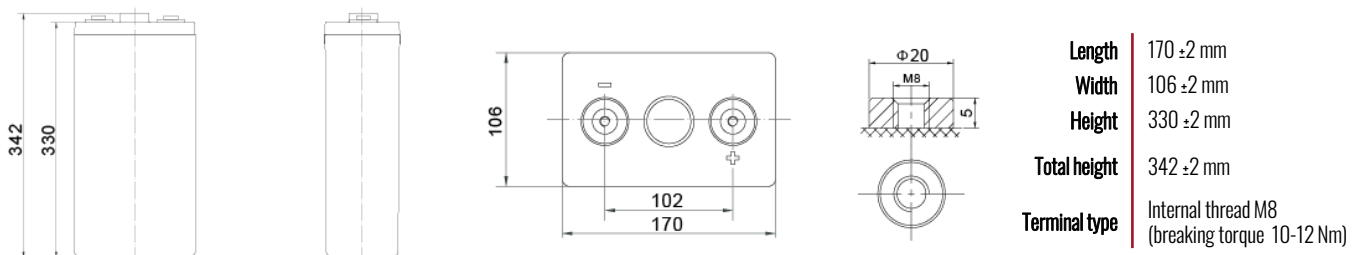

SBL 200-2i

Nominal voltage	2 V	Operating temperature range	Discharge -20°C ~ +60°C
Nominal capacity	200 Ah @ C10 to 1,80 V/cell		Charge 0°C ~ +50°C
Technology	AGM (Absorbent Glass Mat) VRLA (Valve Regulated Lead Acid)		Storage -20°C ~ +60°C
Weight	~ 11,5 kg	Max. discharge current	1000 (5 sec)
Design life time	20 years (standby use) Very Long Life acc. Eurobat	Short circuit current	2650 A
Internal resistance	~ 0,8 mΩ (full charged)	Max. charging current	40 A
		Charging voltage	Standby use 2,27 ~ 2,30 VDC Cycle use 2,43 ~ 2,47 VDC
		Self discharge	Monthly is less than 3% at 25°C
		Container material	ABS UL94HB (optional UL94-V0)



CONSTANT CURRENT DISCHARGE CHARACTERISTICS (A at 25°C)

Voltage/Time	10 MIN	15 MIN	30 MIN	1 H	2 H	3 H	5 H	8 H	10 H	20 H
1.60V	314,6	251,8	171,3	113,2	72,21	53,77	36,12	24,95	20,90	10,97
1.65V	300,5	242,7	167,3	111,5	71,11	53,17	35,82	24,75	20,70	10,87
1.70V	280,4	230,7	161,3	108,6	69,92	52,18	35,22	24,45	20,60	10,82
1.75V	249,2	210,6	152,3	104,1	68,23	51,19	34,73	24,15	20,30	10,66
1.80V	211,1	188,6	142,3	100,1	65,94	50,10	34,03	23,75	20,00	10,50
1.85V	171,9	155,5	122,2	89,31	60,16	46,03	31,54	22,16	18,70	9,818

CONSTANT POWER DISCHARGE CHARACTERISTICS (W/cell at 25°C)

Voltage/Time	10 MIN	15 MIN	30 MIN	1 H	2 H	3 H	5 H	8 H	10 H	20 H
1.60V	534,7	440,3	311,6	212,2	137,0	102,9	69,95	48,90	41,30	21,68
1.65V	521,6	431,3	307,6	209,9	135,9	102,3	69,45	48,70	41,00	21,53
1.70V	494,5	414,2	298,6	205,9	133,6	100,6	68,85	48,20	40,70	21,37
1.75V	448,2	385,2	284,6	199,1	130,7	98,90	67,76	47,70	40,30	21,16
1.80V	385,9	349,0	269,5	192,8	127,9	97,22	66,57	47,01	39,70	20,84
1.85V	319,6	292,9	233,5	172,3	116,9	89,78	61,99	44,01	37,30	19,58

EFFECT OF TEMPERATURE ON LONG TERM LIFE

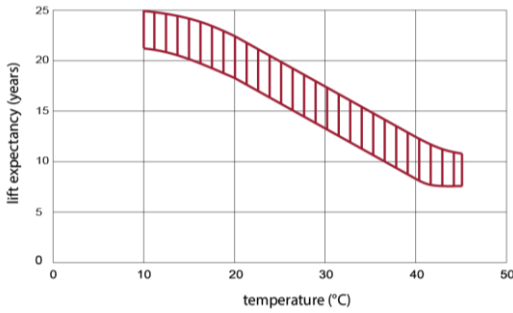

CYCLE LIFE IN RELATION TO DEPTH OF DISCHARGE

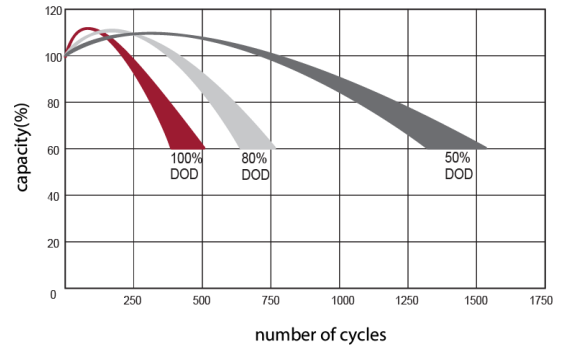

DISCHARGE CHARACTERISTICS CURVE

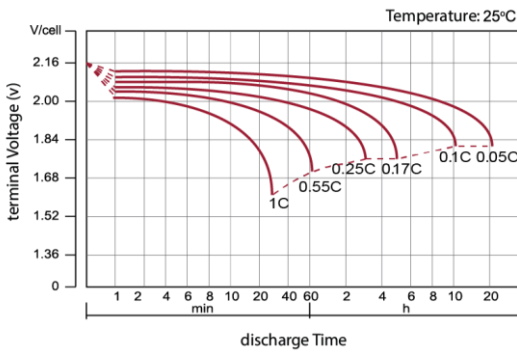

CHARGE CHARACTERISTIC CURVE FOR CYCLE USE

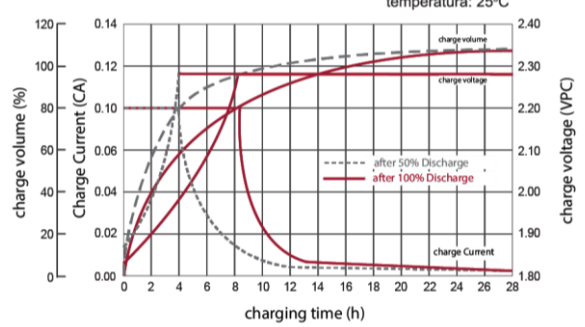

RELATIONSHIP BETWEEN CHARGING VOLTAGE AND TEMPERATURE

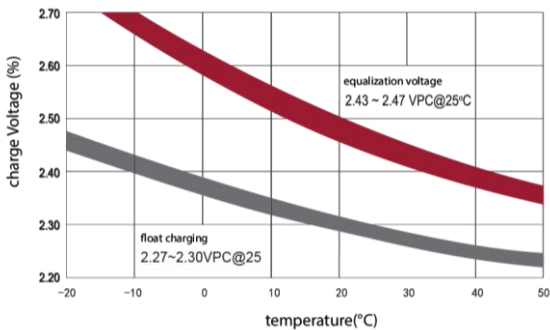

STORAGE CHARACTERISTICS

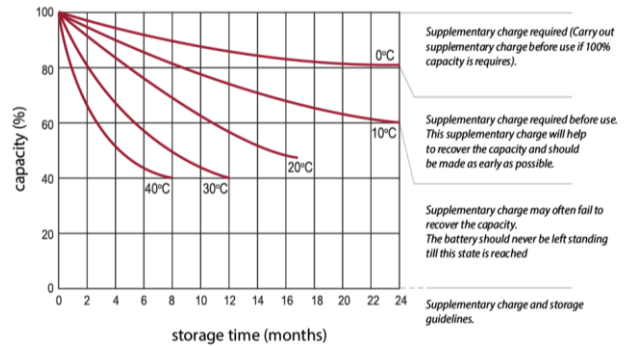

Standards met:

PN-EN 60896-21:2007 • PN-EN 60896-22:2007 • PN-EN 61056-1:2013 • PN-EN 61056-2:2013 • PN-E-83016:1999

Batteries manufactured in compliance with: ISO 9001 • ISO 14001

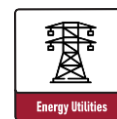
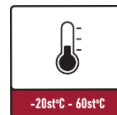
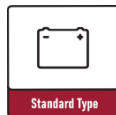

All data contained in this document, are subject to change. Wamtechnik Sp. z o.o. reserves the right to change them without prior notice.