



SBL 134-12i



Nominal voltage	12 V
Nominal capacity	142 Ah @ C20 to 1,75 V/cell
	134,1 Ah @ C10 to 1,80V/cell
Technology	AGM (Absorbent Glass Mat)
	VRLA (Valve Regulated Lead Acid)
Weight	~ 41 kg
Design life time	12 years (standby use)
	Long Life acc. Eurobat
Internal resistance	~ 4,4 mΩ (full charged)

Operating temperature range	Discharge -20°C ~ +60°C
	Charge 0°C ~ +50°C
	Storage -20°C ~ +60°C
Max. discharge current	1340 A (5 sec)
Short circuit current	2480 A
Max. charging current	40,2 A
Charging voltage	Standby use 13,6 ~ 13,8 VDC
	Cycle use 14,6 ~ 14,8 VDC
Self discharge	Monthly is less than 3% at 25°C
Container material	ABS UL94HB (optional UL94-V0)

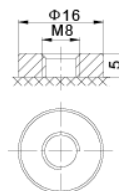
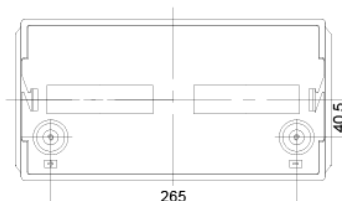
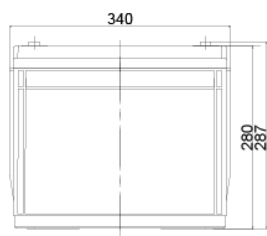

Length	340 ±2 mm
Width	173 ±2 mm
Height	280 ±2 mm
Total height	287 ±2 mm
Internal thread M8 (breaking torque 10-12 Nm)	

CONSTANT CURRENT DISCHARGE CHARACTERISTICS (A at 25°C)

Voltage/Time	10MIN	15MIN	30MIN	60MIN	2H	3H	4H	5H	8H	10H	20H
1.60 V	310,7	244,2	146,7	81,9	48,8	37,8	29,7	25,3	17,0	14,1	7,39
1.65 V	293,6	233,5	140,9	79,1	47,2	36,6	28,9	24,6	16,8	14,0	7,28
1.70 V	270,3	218,7	134,7	76,5	45,7	35,6	28,1	24,0	16,5	13,8	7,19
1.75 V	247,4	203,5	128,7	73,7	44,1	34,6	27,4	23,4	16,3	13,6	7,10
1.80 V	224,0	187,9	123,0	70,9	42,5	33,5	26,6	22,8	16,0	13,4	7,03
1.85 V	183,0	155,9	105,9	63,6	38,9	31,0	24,7	21,2	15,1	12,6	6,68

CONSTANT POWER DISCHARGE CHARACTERISTICS (W/cell at 25°C)

Voltage/Time	10MIN	15MIN	30MIN	60MIN	2H	3H	4H	5H	8H	10H	20H
1.60 V	540,0	428,0	266,5	158,2	96,0	71,1	58,0	49,2	33,3	28,5	14,64
1.65 V	537,3	425,6	259,9	156,9	95,3	70,6	57,6	48,9	33,1	28,3	14,55
1.70 V	521,4	414,1	253,6	153,5	93,7	69,5	56,8	48,2	32,7	27,9	14,41
1.75 V	502,0	400,1	245,9	149,1	91,7	68,1	55,7	47,4	32,1	27,5	14,22
1.80 V	473,3	379,6	235,0	142,9	88,8	66,1	54,2	46,2	31,4	26,9	13,95
1.85 V	434,0	351,4	220,0	135,1	84,9	63,5	52,2	44,6	30,4	26,1	13,60

EFFECT OF TEMPERATURE ON LONG TERM LIFE

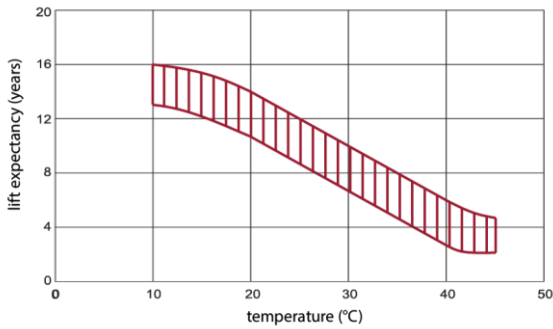

CYCLE LIFE IN RELATION TO DEPTH OF DISCHARGE

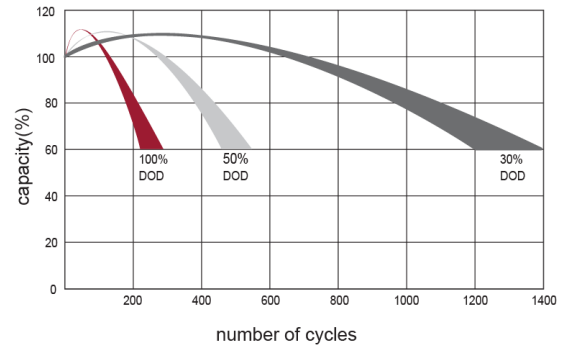

DISCHARGE CHARACTERISTICS CURVE

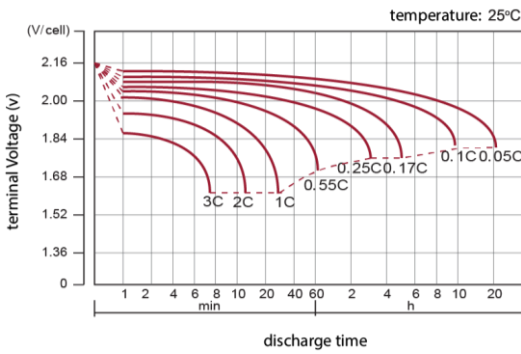

CHARGE CHARACTERISTIC CURVE FOR CYCLE USE

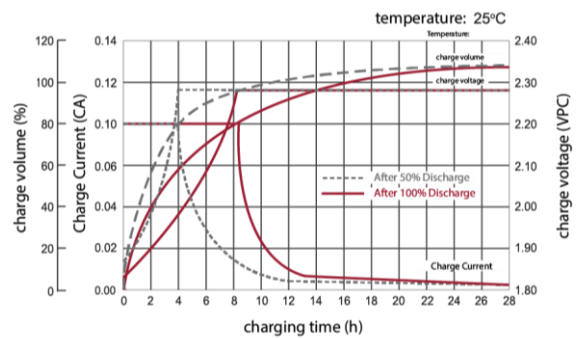

RELATIONSHIP BETWEEN CHARGING VOLTAGE AND TEMPERATURE

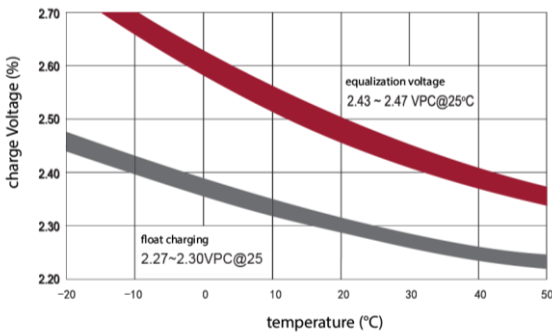

STORAGE CHARACTERISTICS

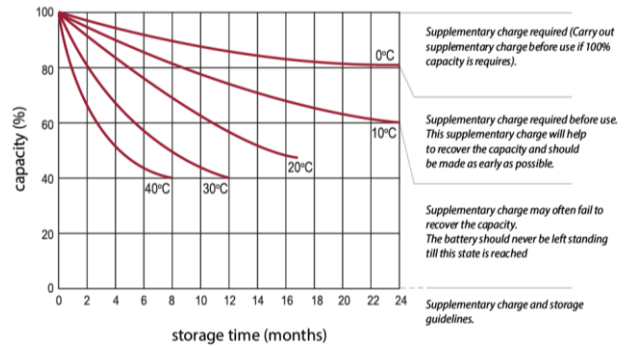

Standards met:

PN-EN 60896-21:2007 • PN-EN 60896-22:2007 • PN-EN 61056-1:2013 • PN-EN 61056-2:2013 • PN-E-83016:1999

Batteries manufactured in compliance with: ISO 9001 • ISO 14001

AGM Technology	VRLA Maintenance Free	Standard Type	-20st°C - 60st°C	Recyclable	10-12 Years Life Expect. EUROBAT
UPS	Emergency Lighting	Fire Alarm Systems	Security Systems	Energy Utilities	DC Power Supply

All data contained in this document, are subject to change. Wamtechnik Sp. z o.o. reserves the right to change them without prior notice.