



SB 1,2-12

VdS G112062



Nominal voltage	12 V
Nominal capacity	1,2 Ah @ C20 to 1,75 V/cell
Technology	AGM (Absorbent Glass Mat)
	VRLA (Valve Regulated Lead Acid)
Weight	~ 0,57 kg
Design life time	6-9 years (standby use)
	General Purpose acc. Eurobat
Internal resistance	~ 115 mΩ (full charged)

Operating temperature range	Discharge -20°C ~ +60°C
	Charge 0°C ~ +50°C
	Storage -20°C ~ +60°C
Maximum discharge current	18 A (5 sec)
Maximum charging current	0,36 A
Charging voltage	Standby use 13,7 ~ 13,9 VDC
	Cycle use 14,6 ~ 14,8 VDC
Self discharge	Monthly is less than 3% at 25°C
Container material	ABS UL94HB (optional UL94-V0)

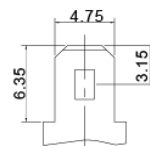
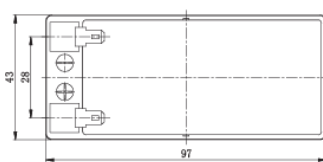
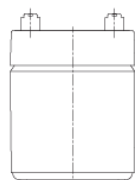
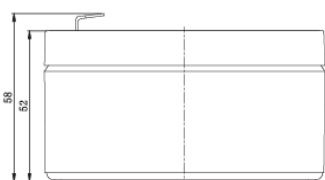

0.8

Length	97 ±1,5 mm
Width	43 ±1,5 mm
Height	52 ±1,5 mm
Total height	58 ±1,5 mm
Terminal types	fast-on 4,8 mm

CONSTANT CURRENT DISCHARGE CHARACTERISTICS (A at 25°C)

Voltage / Time	5MIN	10MIN	15MIN	30MIN	1H	2H	3H	4H	5H	8H	10H	20H
1.60 V	4,86	2,80	2,11	1,25	0,789	0,446	0,319	0,253	0,215	0,144	0,117	0,062
1.65 V	4,58	2,69	2,04	1,22	0,771	0,437	0,314	0,249	0,211	0,142	0,115	0,061
1.70 V	4,43	2,62	1,99	1,20	0,760	0,432	0,311	0,246	0,209	0,141	0,115	0,060
1.75 V	4,23	2,52	1,92	1,17	0,746	0,426	0,306	0,243	0,207	0,139	0,113	0,060
1.80 V	4,01	2,42	1,86	1,14	0,731	0,418	0,301	0,240	0,204	0,138	0,112	0,059
1.85 V	3,73	2,28	1,78	1,10	0,714	0,411	0,296	0,236	0,201	0,136	0,111	0,059

CONSTANT POWER DISCHARGE CHARACTERISTICS (W/cell at 25°C)

Voltage / Time	5MIN	10MIN	15MIN	30MIN	1H	2H	3H	4H	5H	8H	10H	20H
1.60 V	8,68	5,13	3,92	2,37	1,51	0,862	0,621	0,494	0,420	0,284	0,232	0,123
1.65 V	8,34	4,98	3,82	2,32	1,48	0,848	0,612	0,487	0,415	0,280	0,229	0,122
1.70 V	8,13	4,87	3,74	2,28	1,46	0,840	0,607	0,483	0,412	0,278	0,227	0,121
1.75 V	7,84	4,72	3,64	2,23	1,44	0,830	0,599	0,477	0,407	0,275	0,225	0,120
1.80 V	7,52	4,57	3,55	2,19	1,42	0,817	0,591	0,471	0,402	0,273	0,223	0,119
1.85 V	7,06	4,34	3,40	2,13	1,39	0,804	0,583	0,465	0,397	0,269	0,220	0,117

EFFECT OF TEMPERATURE ON LONG TERM LIFE

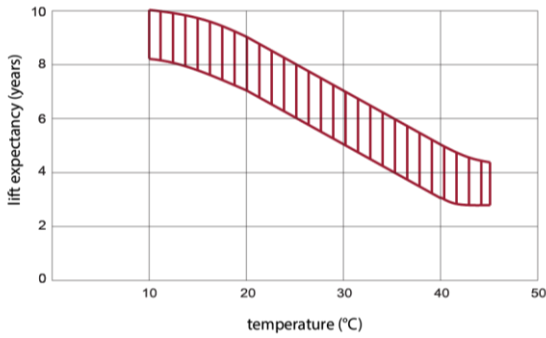

CYCLE LIFE IN RELATION TO DEPTH OF DISCHARGE

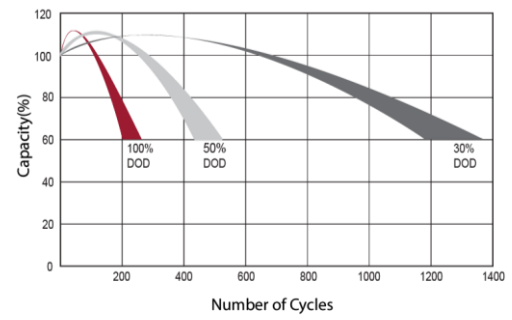

DISCHARGE CHARACTERISTICS CURVE

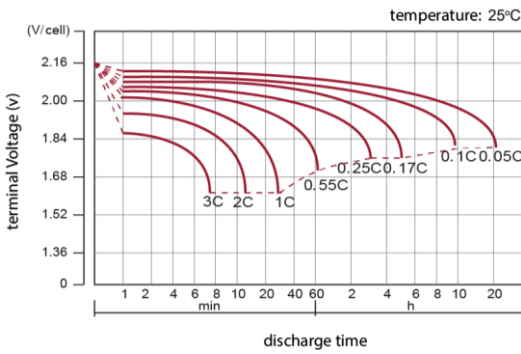

CHARGE CHARACTERISTIC CURVE FOR CYCLE USE

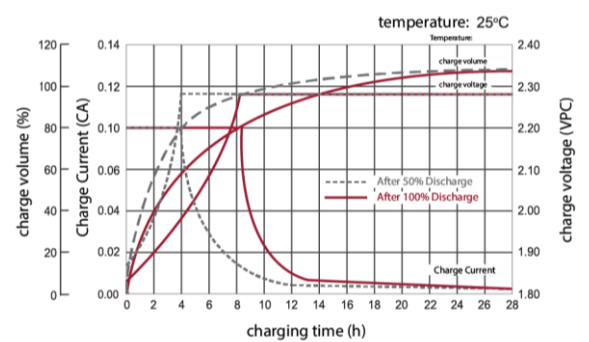

RELATIONSHIP BETWEEN CHARGING VOLTAGE AND TEMPERATURE

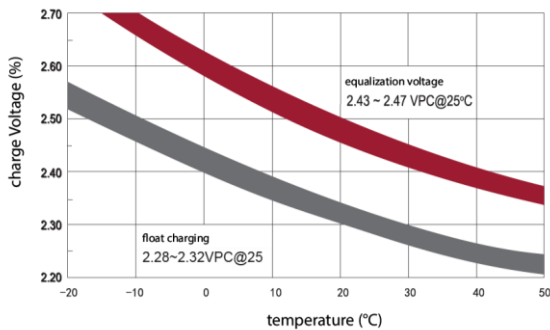

STORAGE CHARACTERISTICS

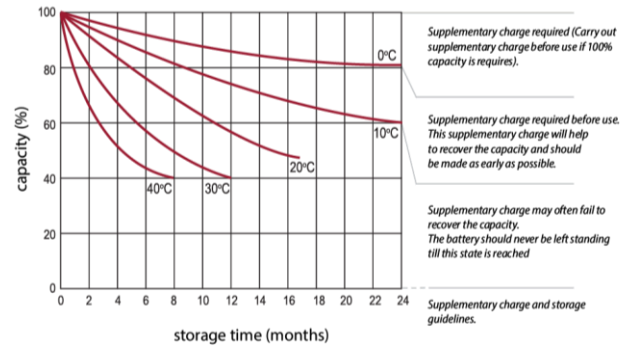

Standards met:

PN-EN 60896-21:2007 • PN-EN 60896-22:2007 • PN-EN 61056-1:2013 • PN-EN 61056-2:2013 • PN-E-83016:1999

Batteries manufactured in compliance with: ISO 9001 • ISO 14001

AGM Technology	VRLA Maintenance Free	Standard Type	-20st°C - 60st°C	Recyclable	6-9 Years Life Expect. EUROBAT
UPS	Emergency Lighting	Fire Alarm System	Security Systems	Energy Utilities	DC Power Supply

All data contained in this document, are subject to change. Wamtechnik Sp. z o.o. reserves the right to change them without prior notice.